

# Vcheck C

Versatile High-throughput Chemistry Platform



# Versatile High-throughput Chemistry Analyzer



## Simple 3-STEP Test Procedure

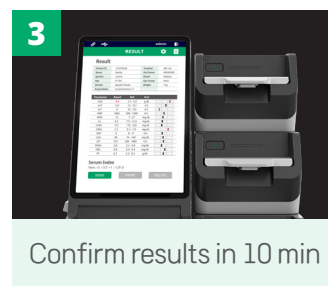
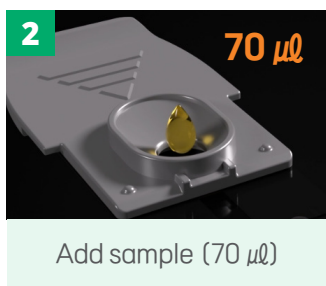
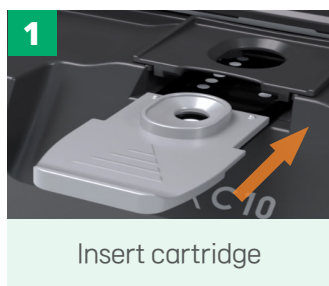

## Scale Up Possible for Testing Up to 4 Samples at Once, Depending on the Situation

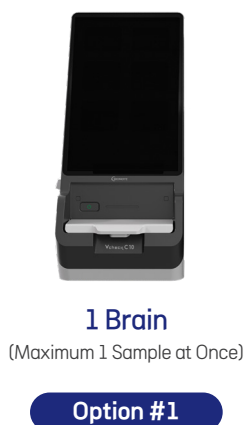

## Precise PoC Dry Chemistry Cartridge

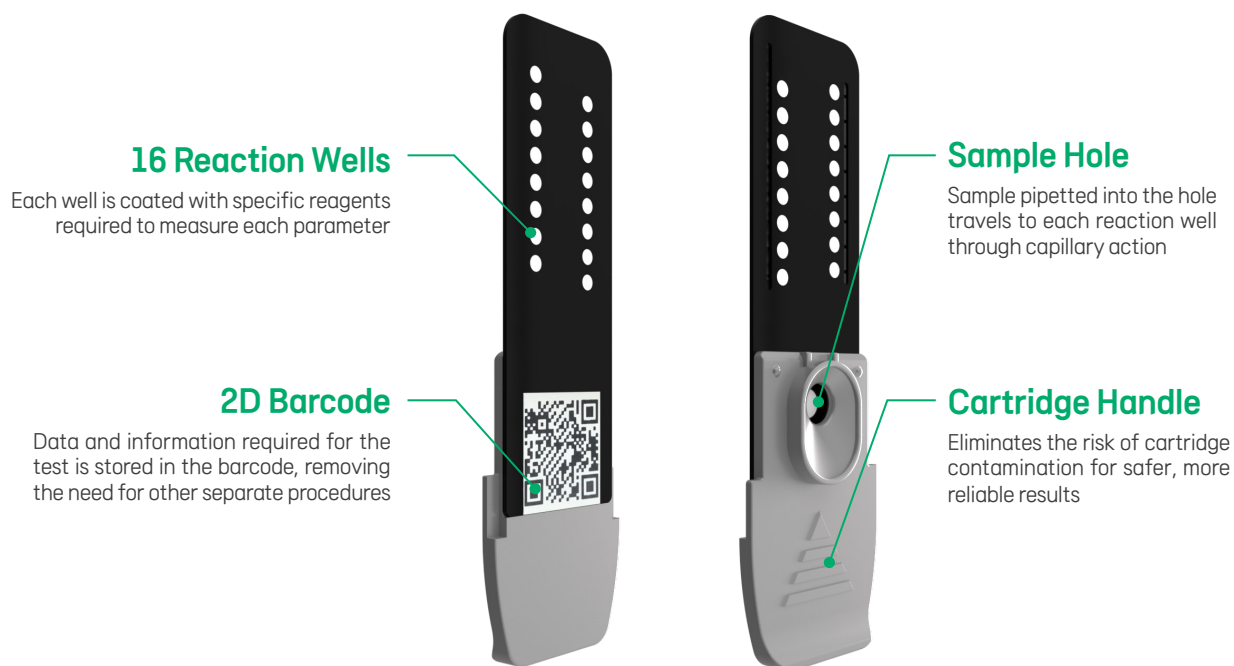

## How Vcheck C Cartridge Works

The samples pipetted onto the cartridge travel to the reaction wells through capillary action, and once the sample reacts to the reagents coated onto the reaction wells, the color within the wells change in color.

The light emitted by the LED travels through the reaction well to the photodiode detector. The detector analyzes the difference between light emitted by the LED and light that passed through the reaction well to calculate the absorbance, using it to determine the concentration of each parameter.

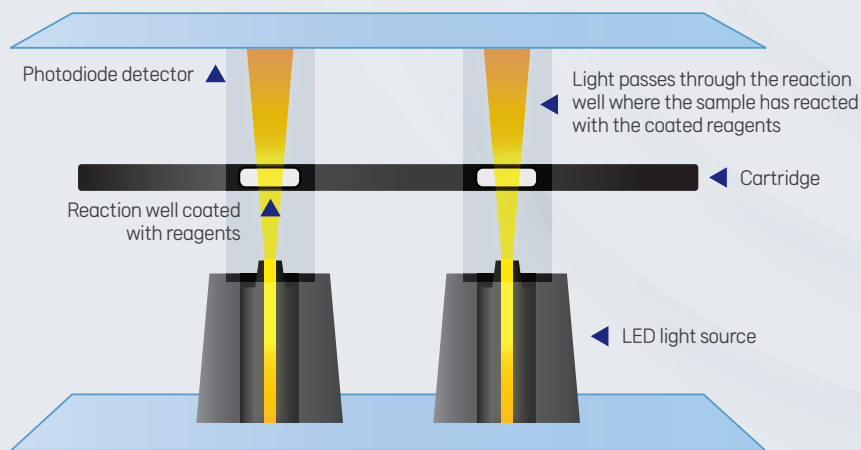

**Sample 70  $\mu\text{l}$**

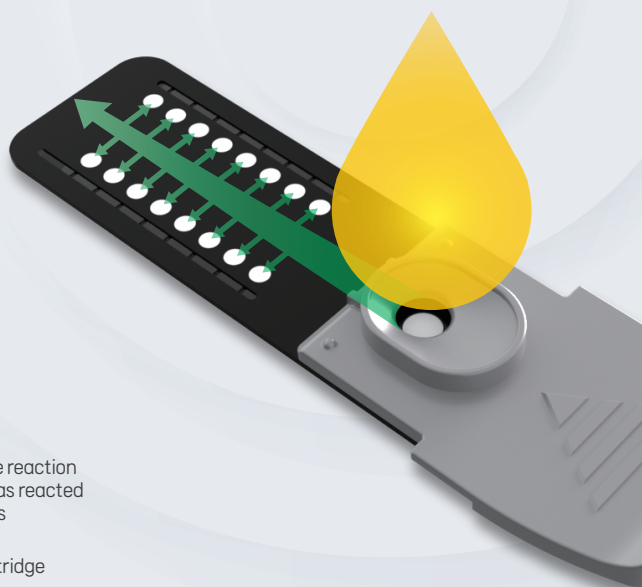

## Vcheck C10 Test Item Parameters

Category	Parameter	Comprehensive 17	Presurgical 10	Electrolyte 4	UPC	Dual Panel
Chemistry Parameters	ALT	○	○			ALP + ALT
	AST					ALT + AST
	ALP	○	○			TBIL + GGT
	GGT	○				ALB + TP
	TP	○	○			AMY + LIP
	ALB	○	○			CHOL + TRIG
	TBIL	○				BUN + CREA
	AMY	○				Ca + PHOS
	LIP	○				
	GLU	○	○			
	CHOL	○				
	TRIG					
	BUN	○	○			
	CREA	○	○			
	PHOS	○				
	UP				○	
	UCREA				○	
	Ca	○				
Electrolyte Parameters	Na			○		
	K			○		
	Cl			○		
Calculated Parameters	A/G <sup>1</sup>	○	○			
	B/C <sup>2</sup>	○	○			
	GLOB	○	○			
	Na/K <sup>3</sup>			○		
	UP/C <sup>4</sup>				○	

<sup>1</sup> Albumin / Globulin   <sup>2</sup> Blood Urea Nitrogen / Creatinine   <sup>3</sup> Sodium / Potassium   <sup>4</sup> Urine Protein / Creatinine

## Vcheck C10 Brain & Limb

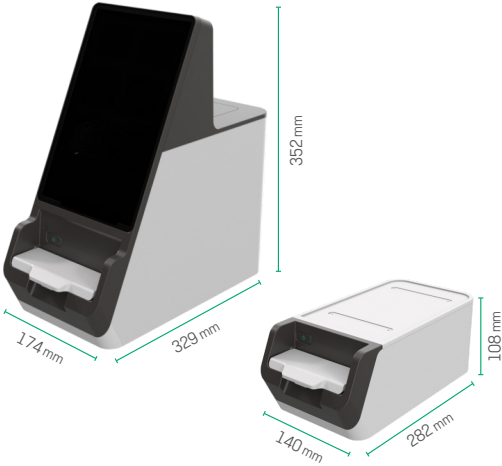
	<b>Channels</b>	Up to 4 channels (1 Brain + 3 Limbs)
	<b>Samples</b>	Up to 4 samples at once (1 per channel)
	<b>Input Voltage</b>	Vcheck C10 Brain: AC100~240V, 50/60Hz Vcheck C10 Limb: 12Vdc, 1.5A (Limb cannot be used without a Brain)
	<b>Display</b>	10.1 inch touchscreen
	<b>Display Control</b>	Graphic User Interface (GUI)
	<b>Power Consumption</b>	Vcheck C10 Brain : 84W Vcheck C10 Brain + 3 Limbs : 84W
	<b>Storage Capacity</b>	30,000 (Tests)
	<b>Communication</b>	USB, ethernet, Wi-Fi (2.4GHz, 5GHz)
	<b>LIS/HIS</b>	HL7 profile support